

Terminals

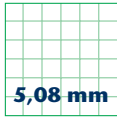

5,08 mm

PK 250/... /5,08-V vertical

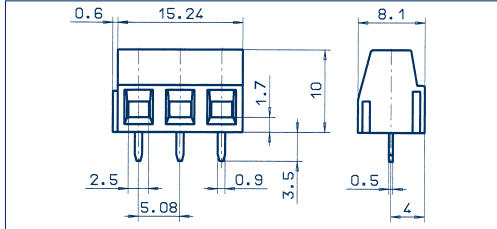
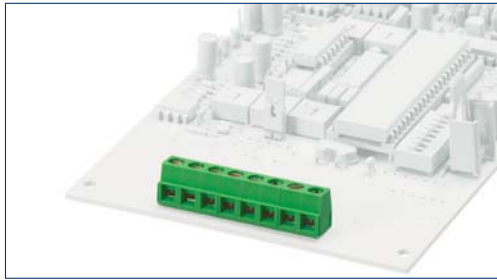

PK 300/... /5,08

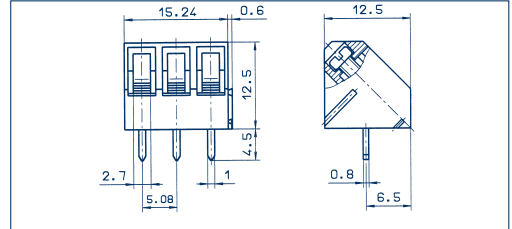
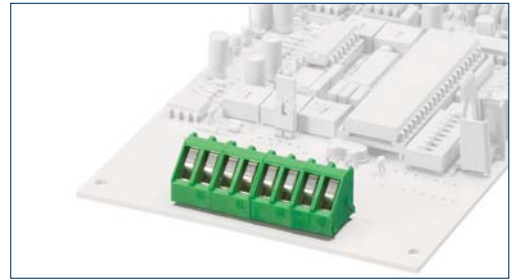

Drawings

Connection principle

Dimensions

| | |
|--------------------------------|------|
| Spacing mm | 5,08 |
| Insulation stripping length mm | 6,00 |
| PCB hole diameter mm | 1,30 |

Connection data

| | |
|---|------|
| Single wire (solid) mm ² | 1,50 |
| Stranded wire (flexible) mm ² | 1,50 |
| Stranded wire (with ferrules) mm ² | 1,50 |

Rating

| | | |
|--|-------|------------|
| Rated voltage V | 300 V | 250 V |
| Rated current A | 15 A | 13 A (T60) |
| Cross section max. AWG/mm ² | 28-14 | 1,50 |
| Rated surge voltage | – | 2,00 kV |
| Rated torque/Screw size | – | 0,50 Nm/M3 |
| Contamination degree | – | – |

Materials

| | |
|--|----------------------|
| Insulating material/Flammability class | PA 6.6 V0 / UL 94 V0 |
| Temperature Range | -30°C / +105°C |
| Clamping part | CuZn |
| Clamping cage/Eccentric | – |
| Contact pin | – |
| Cage tension spring | – |
| Wire protection | – |
| Soldering lug | Cu |
| Contact Spring | – |

Order information

Standard colour(s)
(further colours on request, see page 5)

Strain-relief-clamp

| | |
|---|------|
| Spacing mm | 5,08 |
| Insulation stripping length mm | 6,00 |
| PCB hole diameter mm | 1,30 |
| Single wire (solid) mm ² | 1,50 |
| Stranded wire (flexible) mm ² | 1,50 |
| Stranded wire (with ferrules) mm ² | 1,50 |

| | | |
|--|-------|------------|
| Rated voltage V | 300 V | 250 V |
| Rated current A | 15 A | 13 A (T60) |
| Cross section max. AWG/mm ² | 28-14 | 1,50 |
| Rated surge voltage | – | 2,00 kV |
| Rated torque/Screw size | – | 0,50 Nm/M3 |
| Contamination degree | – | – |

| | |
|--|----------------------|
| Insulating material/Flammability class | PA 6.6 V0 / UL 94 V0 |
| Temperature Range | -30°C / +105°C |
| Clamping part | CuZn |
| Clamping cage/Eccentric | – |
| Contact pin | – |
| Cage tension spring | – |
| Wire protection | – |
| Soldering lug | Cu |
| Contact Spring | – |

Order information

| No. of poles | Cat.-No. | | Qty.p.pck. |
|--------------|-----------------------|---------------------------|------------|
| | ● green (Ral 6018) | ● dark grey (Ral 7016) | |
| 2 | 10291.1 | 10291.4 | 50 |
| 3 | 10292.1 | 10292.4 | 50 |
| 4 | 10293.1 | 10293.4 | 50 |
| 5 | 10294.1 | 10294.4 | 50 |
| 6 | 10295.1 | 10295.4 | 50 |
| 7 | 10296.1 | 10296.4 | 50 |
| 8 | 10297.1 | 10297.4 | 50 |
| 9 | 10298.1 | 10298.4 | 50 |
| 10 | 10299.1 | 10299.4 | 50 |
| 11 | 10300.1 | 10300.4 | 50 |
| 12 | 10301.1 | 10301.4 | 50 |
| 13 | 12541.1 | 12541.4 | 50 |
| 14 | 12542.1 | 12542.4 | 50 |
| 15 | 12543.1 | 12543.4 | 50 |
| 16 | 12544.1 | 12544.4 | 50 |
| 17 | 12545.1 | 12545.4 | 50 |
| 18 | 12546.1 | 12546.4 | 50 |
| 19 | 12547.1 | 12547.4 | 50 |
| 20 | 12548.1 | 12548.4 | 50 |
| 21 | 12549.1 | 12549.4 | 50 |
| 22 | 12550.1 | 12550.4 | 50 |
| 23 | 12551.1 | 12551.4 | 50 |
| 24 | 12552.1 | 12552.4 | 50 |

Strain-relief-clamp

| | |
|---|------|
| Spacing mm | 5,08 |
| Insulation stripping length mm | 7,00 |
| PCB hole diameter mm | 1,30 |
| Single wire (solid) mm ² | 2,50 |
| Stranded wire (flexible) mm ² | 1,50 |
| Stranded wire (with ferrules) mm ² | 1,50 |

| | | |
|--|-------|--------------|
| Rated voltage V | 300 V | 250 V |
| Rated current A | 15 A | 24 A (T60) |
| Cross section max. AWG/mm ² | 22-12 | 2,50 |
| Rated surge voltage | – | 2,00 kV |
| Rated torque/Screw size | – | 0,50 Nm/M2,6 |
| Contamination degree | – | – |

| | |
|--|----------------------|
| Insulating material/Flammability class | PA 6.6 V0 / UL 94 V0 |
| Temperature Range | -30°C / +105°C |
| Clamping part | CuZn |
| Clamping cage/Eccentric | – |
| Contact pin | – |
| Cage tension spring | – |
| Wire protection | – |
| Soldering lug | Cu |
| Contact Spring | – |

Order information

| No. of poles | Cat.-No. | | Qty.p.pck. |
|--------------|-----------------------|---------------------------|------------|
| | ● green (Ral 6018) | ● dark grey (Ral 7016) | |
| 2 | 10324.1 | 10324.4 | 50 |
| 3 | 10325.1 | 10325.4 | 50 |
| 4 | 10326.1 | 10326.4 | 50 |
| 5 | 10327.1 | 10327.4 | 50 |
| 6 | 10328.1 | 10328.4 | 50 |
| 7 | 10329.1 | 10329.4 | 50 |
| 8 | 10330.1 | 10330.4 | 50 |
| 9 | 10331.1 | 10331.4 | 50 |
| 10 | 10332.1 | 10332.4 | 50 |
| 11 | 10333.1 | 10333.4 | 50 |
| 12 | 10334.1 | 10334.4 | 50 |
| 13 | 12565.1 | 12565.4 | 50 |
| 14 | 12566.1 | 12566.4 | 50 |
| 15 | 12567.1 | 12567.4 | 50 |
| 16 | 12568.1 | 12568.4 | 50 |
| 17 | 12569.1 | 12569.4 | 50 |
| 18 | 12570.1 | 12570.4 | 50 |
| 19 | 12571.1 | 12571.4 | 50 |
| 20 | 12572.1 | 12572.4 | 50 |
| 21 | 12573.1 | 12573.4 | 50 |
| 22 | 12574.1 | 12574.4 | 50 |
| 23 | 12575.1 | 12575.4 | 50 |
| 24 | 12576.1 | 12576.4 | 50 |

Accessories

Marking

Page 126 - 129

Page 126 - 129