

SYMBOL DEFINITION				MISSING NUMBERS		DWG STATUS			ZONE	REVISION HISTORY			AUTH	DR	CK	APVD	
DATE	STG	REV	CHG	N/P													
04N098	R	001	-	-							ALL PARTS - REDRAWN TO PD; 12047948			188898	GEG	GMC	JR
04N098	R	002	-	-							ALL PARTS - UPDATED PDM ATTRIBUTES			191525	GEG	GMC	JR
045E00	R	003	-	-							12186478 - MATL' SPEC WAS R0063785			202903	JYD	GMC	DN

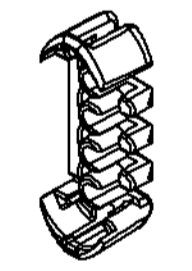
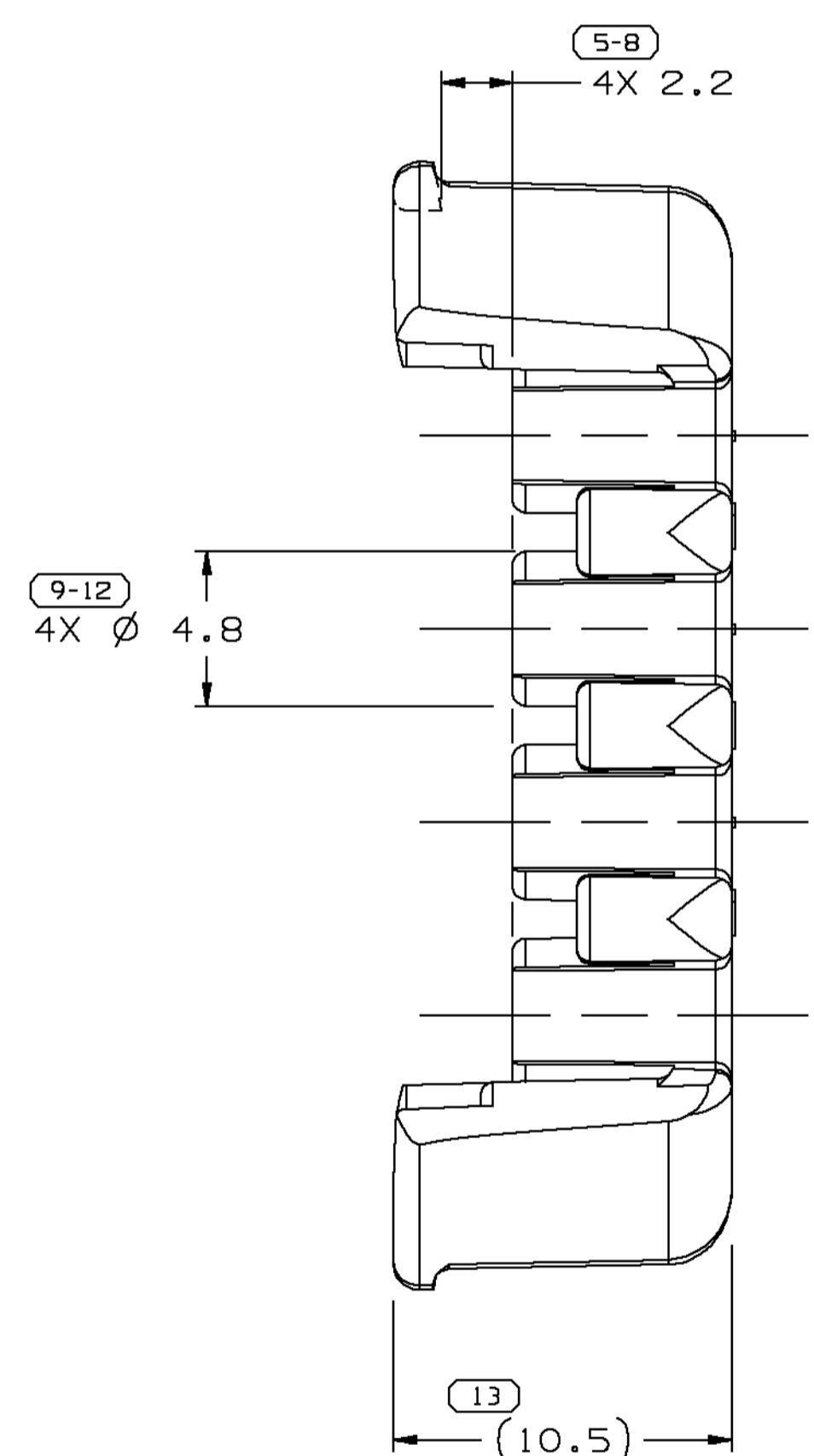
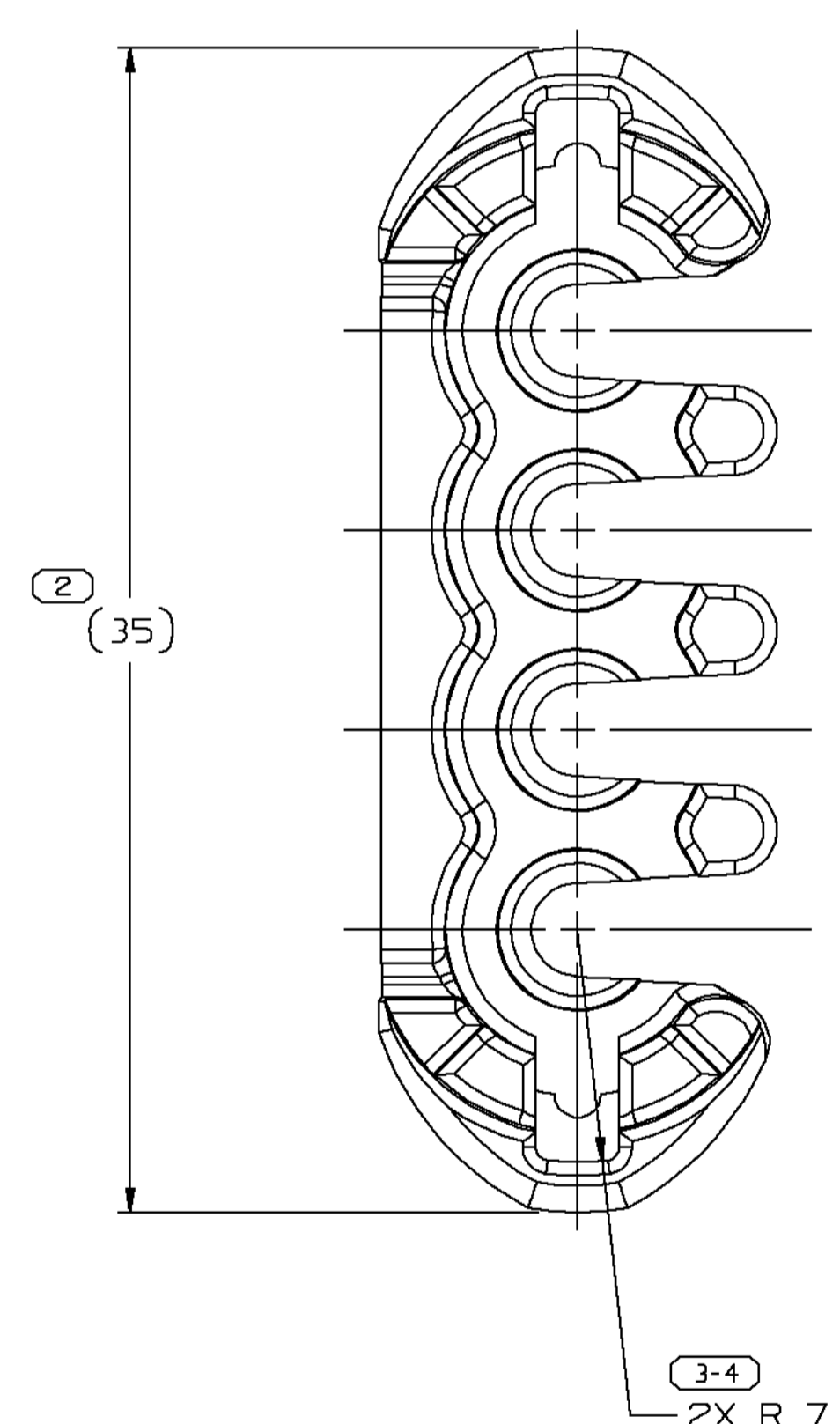
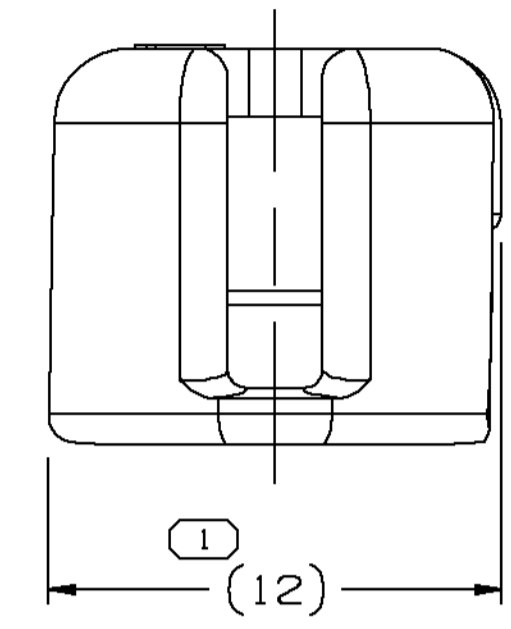

NOTES

- UNLESS OTHERWISE SPECIFIED AND/OR INDICATED: DIMENSIONS ARE TO FACE OF VIEW SHOWN AND AUTOMATICALLY ROUNDED BY COMPUTER FOR INSPECTION. (SEE MATH MODEL FOR PRECISE DIMENSIONS.) FOR ALL OTHER DIMENSIONS NOT SHOWN BUT REQUIRED FOR TOOL BUILD, SEE MATH MODEL FOR PRECISE TOOL PATH DATA.
- MATING COMPONENTS OR EQUIVALENT: CONNECTOR 12047947

DELPHI Automotive Systems		DIMENSIONAL RANGE (MM) CHART E	
MATERIAL SPEC SEE CHART		FROM TO	> 20 > 30 > 70 > 100
		TOLERANCE UNLESS OTHERWISE SPECIFIED	
		±0.15 ±0.2 ±0.3 ±0.4 ±0.5	
		ANGULAR TOLERANCE ± 2°	
PART DRAWING			
CODE NUMBER 6900	DWG DATE 24FE96	SCALE 5:1	DISTR CODE
QC SPEC	STYLE	VOLUME cm³ SEE DWG	
PART GEOMETRY 3D SOLID		UNLESS OTHERWISE SPECIFIED:	
 CHANGE RESTRICTED NO MANUAL CHANGES		PERFECT FORM REQUIRED FOR FEATURES OF SIZE AT MMC. TRUE POSITION TOLERANCES AND RELATED DATUMS APPLY AT CONDITION OF SIZE INDICATED IN FEATURE CONTROL FRAME. ALL OTHER GEOMETRIC TOLERANCES AND RELATED DATUMS APPLY RFS. SEPARATE TRUE POSITION CALLOUTS MAY BE GAGED SEPARATELY, REGARDLESS OF DATUM REFERENCE.	
COPY OF MATH DATA DO NOT SCALE		REFERENCE 001,701	DATE
METRIC UNLESS OTHERWISE SPECIFIED, ALL DIMENSIONS ARE IN MILLIMETERS		APVD1 G. ESTRADA	04N098
		APVD2 G. MACIAS	10N098
		APVD3 J. REIDER	15MR99
		APVD4	
		APVD5	
THIRD ANGLE PROJECTION 		DRAWING NAME TAXI TPA M/P 150	
SHEET NUMBER 1 OF 1		DRAWING NUMBER 12186580	
PART NO		DWG STATUS	
STG		REV	
REV		N/P	
N/P		SIZE A1	
STATUS		R 003 -	
MATERIAL SPECIFICATION AND COLOR			
VOL CM³			
DIMENSIONS ENCLOSED IN () INDICATE REFERENCE DIMENSIONS AND NO TOLERANCE LIMITS ARE ESTABLISHED			

12186478	R	002	-		R0071769 PA66 HS IM GRA-LT	1.228
12047948	R	F	-		R0071754 PA66 HS IM-BLK	1.228
					(9-12) PROCESS SENSITIVE DIMENSION	
PART NO	STG	REV	N/P	STATUS	MATERIAL SPECIFICATION AND COLOR	VOL CM³