

## P.C. board plug-in connectors

Header

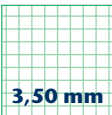

## Drawings

### STL 1350/... /3,50-V vertical

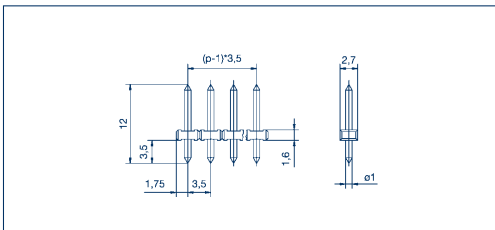
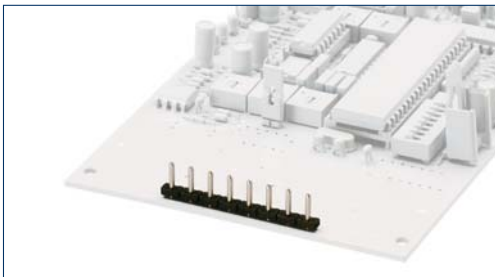

### STL 1350/... /3,50-H horizontal

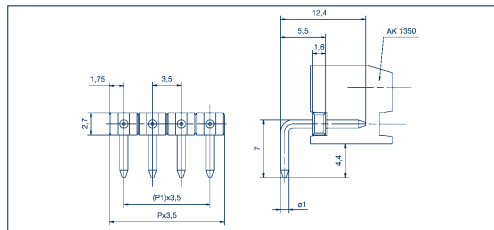
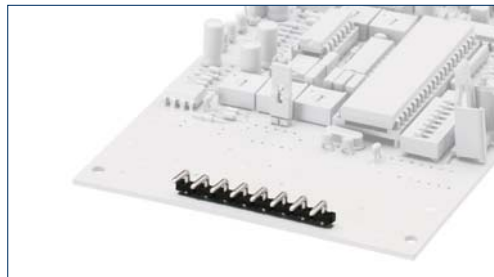

## Connection principle

### Dimensions

Spacing mm	3,50
Insulation stripping length mm	—
PCB hole diameter mm	1,30

### Connection data

Single wire (solid) mm <sup>2</sup>	—
Stranded wire (flexible) mm <sup>2</sup>	—
Stranded wire (with ferrules) mm <sup>2</sup>	—

### Rating

Rated voltage V	150 V
Rated current A	9 A
Cross section max. AWG/mm <sup>2</sup>	—
Rated surge voltage	—
Rated torque/Screw size	—
Contamination degree	—

### Materials

Insulating material/Flammability class	PA 6.6 V0 / UL 94 V0
Temperature Range	-30°C / +105°C
Clamping part	—
Clamping cage/Eccentric	—
Contact pin	CuZn
Cage tension spring	—
Wire protection	—
Soldering lug	—
Contact Spring	—

### Order information

Standard colour(s)	● black
(further colours on request, see page 5)	

No. of poles	Cat.-No.	Qty.p.pck.
	● black	
	(Ral 9011)	
2	13911.4	50
3	13912.4	50
4	13913.4	50
5	13914.4	50
6	13915.4	50
7	13916.4	50
8	13917.4	50
9	13918.4	50
10	13919.4	50
11	13920.4	50
12	13921.4	50
13	13922.4	50
14	13923.4	50
15	13924.4	50
16	13925.4	50
17	13926.4	50
18	13927.4	50
19	13928.4	50
20	13929.4	50
21	13930.4	50
22	13931.4	50
23	13932.4	50
24	13933.4	50

## Dimensions

Spacing mm	3,50
Insulation stripping length mm	—
PCB hole diameter mm	1,30

Single wire (solid) mm <sup>2</sup>	—
Stranded wire (flexible) mm <sup>2</sup>	—
Stranded wire (with ferrules) mm <sup>2</sup>	—

Rated voltage V	150 V
Rated current A	9 A
Cross section max. AWG/mm <sup>2</sup>	—
Rated surge voltage	—
Rated torque/Screw size	—
Contamination degree	—

Insulating material/Flammability class	PA 6.6 V0 / UL 94 V0
Temperature Range	-30°C / +105°C
Clamping part	—
Clamping cage/Eccentric	—
Contact pin	CuZn
Cage tension spring	—
Wire protection	—
Soldering lug	—
Contact Spring	—

No. of poles	Cat.-No.	Qty.p.pck.
	● black	
	(Ral 9011)	
2	13934.4	50
3	13935.4	50
4	13936.4	50
5	13937.4	50
6	13938.4	50
7	13939.4	50
8	13940.4	50
9	13941.4	50
10	13942.4	50
11	13943.4	50
12	13944.4	50
13	13945.4	50
14	13946.4	50
15	13947.4	50
16	13948.4	50
17	13949.4	50
18	13950.4	50
19	13951.4	50
20	13952.4	50
21	13953.4	50
22	13954.4	50
23	13955.4	50
24	13956.4	50