

## Increased Strain Relief with Bend Protection – PG External Thread

Polyamide (PA)



- Protection Rating: IP65; NEMA 4X
- Neoprene Seal Rings Factory Installed on Nickel Plated Brass Cord Grips
- Order Seal Rings Separately for Polyamide & Polyvinylidene Cord Grips
- Order Locknuts Separately
- Standard Colors: Beige, Black, or Opaque



With Thermoplastic Elastomer (TPE-V)/ Polyamide (PA) Tubular Sealing Insert

Material Specifications	
<b>Body</b>	Polyamide (PA)
<b>Insert</b>	(TPE)/(PA)
<b>Seal Ring</b>	–
Temperature Range	
<b>Body</b>	-20 to 100°C (-4 to 212°F)
<b>Insert</b>	-20 to 100°C (-4 to 212°F)
<b>Seal Ring</b>	–
<b>Insert Color</b>	Black

Size	Cable Dia.		Mtg. Hole Dia.		Std. Pk.	Cat. No.	
	mm	(in.)	mm	(in.)		Beige	Black
PG9	4.0-6.5	(.16-.26)	15.2	(.60)	25	20800.0	20820.1
PG9	7.5-9.0	(.30-.35)	15.2	(.60)	25	20801.0	20821.1
PG11	7.5-9.0	(.30-.35)	18.5	(.73)	25	20802.0	20822.1
PG11	8.5-10.5	(.33-.41)	18.5	(.73)	25	20803.0	20823.1
PG13.5	6.5-9.5	(.26-.37)	20.5	(.81)	25	20804.0	20824.1
PG13.5	8.5-10.5	(.33-.41)	20.5	(.81)	25	20805.0	20825.1
PG16	6.5-9.5	(.26-.37)	22.5	(.89)	10	20806.0	20826.1
PG16	8.5-10.5	(.33-.41)	22.5	(.89)	10	20807.0	20827.1
PG16	9.5-13.0	(.37-.51)	22.5	(.89)	10	20808.0	20828.1
PG21	9.5-13.0	(.37-.51)	28.5	(1.12)	10	20809.0	20829.1
PG21	13.0-15.5	(.51-.61)	28.5	(1.12)	10	20810.0	20830.1
PG21	14.0-17.5	(.55-.69)	28.5	(1.12)	10	20811.0	20831.1
PG29	17.0-20.0	(.67-.79)	37.0	(1.46)	5	20812.0	20832.1
PG29	21.0-24.5	(.83-.96)	37.0	(1.46)	5	20813.0	20833.1

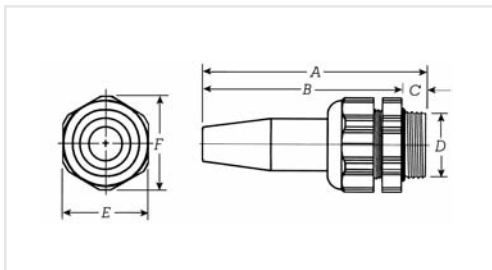

Cord Grip Dimensions: mm (in.) Polyamide (PA) & Polyvinylidene (PVDF)							
Size	A	B	C	D	E	F	
PG9	64.0 (2.52)	55.0 (2.17)	9.0 (.35)	15.2 (.60)	19.0 (.75)	21.2 (.83)	
PG11	73.0 (2.87)	64.0 (2.52)	9.0 (.35)	18.6 (.73)	22.0 (.87)	24.4 (.96)	
PG13.5	81.0 (3.19)	72.0 (2.83)	9.0 (.35)	20.4 (.80)	24.0 (.94)	26.5 (1.04)	
P16	89.0 (3.50)	80.0 (3.15)	9.5 (.37)	22.5 (.89)	27.0 (1.06)	29.5 (1.16)	
PG21	91.0 (3.58)	80.0 (3.15)	11.0 (.43)	28.3 (1.14)	33.0 (1.30)	36.5 (1.44)	
PG29	115.0 (4.53)	104.0 (4.09)	11.0 (.43)	37.0 (1.46)	43.0 (1.69)	46.5 (1.83)	