

# Locknuts – Metric Thread Metal

## Nickel Plated Brass (NPB)



## Brass (BR)



## Chrome Plated Brass (CPB)



Material Specifications	Nickel Plated Brass (NPB)		Brass (BR)		Chrome Plated Brass (CPB)	
Temperature Range	-40 to 300°C (-40 to 572°F)		-40 to 300°C (-40 to 572°F)		-40 to 300°C (-40 to 572°F)	
Size	Cat. No.	Std. Pk.	Cat. No.	Std. Pk.	Cat. No.	Std. Pk.
M6x.75	97614.9	100	–	–	–	–
M8x1	97610.9	100	–	–	–	–
M10x1	97611.9	100	–	–	–	–
M10x1.5	97612.9	100	–	–	–	–
M12x1.5	25500.9	100	–	–	–	–
M16x1.5	25501.9	100	98719.9	50	98720.9	50
M18x1.5	98710.9	100	98701.9	50	98721.9	50
M20x1.5	25502.9	100	98730.9	50	98740.9	50
M24x1.5	78711.9	50	98702.9	50	98722.9	50
M25x1.5	25503.9	100	98731.9	50	98741.9	50
M30x2	98712.9	50	98703.9	50	98723.9	50
M32x1.5	25504.9	100	98732.9	50	98742.9	50
M32x2	98747.9	50	98748.9	50	98749.9	50
M36x2	98713.9	50	98704.9	50	98724.9	50
M40x1.5	25505.9	50	98733.9	50	98743.9	50
M45x2	98714.9	25	98705.9	25	98725.9	25
M50x1.5	25506.9	50	98734.9	25	98744.9	25
M56x2	98715.9	20	98706.9	20	98726.9	20
M63x1.5	25507.9	50	98735.9	10	98745.9	10
M72x2	25508.9	10	98707.9	10	98727.9	10
M75x1.5	25509.9	10	98736.9	5	98746.9	5
M80x2	97613.9	5	98708.9	5	98728.9	5
M85x2	98949.9	5	–	–	–	–
M90x2	97015.9	5	–	–	–	–
M100x2	97106.9	5	–	–	–	–
M105x2	98718.9	5	98709.9	5	98729.9	5
M120x2	98952.9	1	–	–	–	–

Dimensions: mm (in.)			
Size	E	F	G
M6x.75	8.0 (.31)	9.0 (.35)	2.8 (.11)
M8x1	11.0 (.43)	12.2 (.48)	2.8 (.11)
M10x1	14.0 (.55)	15.5 (.61)	2.8 (.11)
M10x1.5	14.0 (.55)	15.5 (.61)	2.8 (.11)
M12x1.5	15.0 (.59)	16.5 (.65)	2.8 (.11)
M16x1.5	19.0 (.75)	21.0 (.83)	2.8 (.11)
M18x1.5	22.0 (.87)	25.0 (.98)	4.0 (.16)
M20x1.5	24.0 (.94)	27.0 (1.06)	3.0 (.12)
M24x1.5	30.0 (1.18)	35.0 (1.38)	5.0 (.20)
M25x1.5	30.0 (1.18)	33.5 (1.32)	3.5 (.14)
M30x2	36.0 (1.42)	42.0 (1.65)	6.0 (.24)
M32x1.5	36.0 (1.42)	40.0 (1.57)	4.0 (.16)

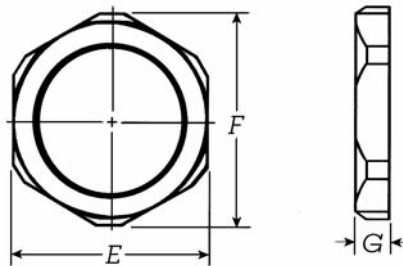

Dimensions: mm (in.)			
Size	E	F	G
M32x2	36.0 (1.42)	42.0 (1.65)	6.0 (.24)
M36x2	41.0 (1.61)	47.0 (1.85)	7.0 (.28)
M40x1.5	46.0 (1.81)	50.0 (1.97)	5.0 (.20)
M45x2	55.0 (2.17)	64.0 (1.81)	8.0 (.32)
M50x1.5	60.0 (2.36)	65.0 (2.56)	5.0 (.20)
M56x2	65.0 (2.56)	70.0 (2.76)	9.0 (.35)
M63x1.5	70.0 (2.76)	75.0 (2.95)	6.0 (.24)
M72x2	85.0 (3.35)	92.0 (3.62)	10.0 (.39)
M75x1.5	80.0 (3.15)	87.0 (3.43)	8.0 (.32)
M80x2	90.0 (3.54)	100.0 (3.94)	11.0 (.43)
M85x2	95.0 (3.74)	102.0 (4.02)	8.0 (.32)
M90x2	120.0 (4.72)	128.0 (5.04)	8.0 (.32)
M100x2	120.0 (4.72)	128.0 (5.04)	8.0 (.32)
M105x2	120.0 (4.72)	130.0 (5.12)	14.0 (.55)
M120x2	145.0 (5.71)	155.0 (6.10)	8.0 (.32)