

**PLEASE CHECK WWW.MOLEX.COM FOR LATEST PART INFORMATION**

**Part Number:** **0190330005**  
**Status:** **Active**  
**Overview:** Snap Plugs and Receptacles  
**Description:** Krimptite Snap Plug, for 14-16 AWG Wire

**Documents:**

[Drawing \(PDF\)](#) [Product Specification PS-19902-013-001 \(PDF\)](#)  
[Product Specification PS-19902-011-001 \(PDF\)](#) [RoHS Certificate of Compliance \(PDF\)](#)

**Agency Certification**

CSA LR18689  
 UL E152602

**General**

Product Family Quick Disconnects  
 Series 19033  
 Crimp Quality Equipment Yes  
 Insulated No  
 Overview Snap Plugs and Receptacles  
 Product Name Krimptite  
 Type Snap Plug  
 UPC 800755058987

**Physical**

Barrel Type Closed  
 Gender Male  
 Glow-Wire Capable No  
 Insulation None  
 Lock to Mating Part None  
 Material - Metal Brass  
 Material - Plating Mating Tin  
 Material - Plating Termination Tin  
 Net Weight 1.397/g  
 Orientation Straight  
 Packaging Type Bag  
 Tab Thickness N/A  
 Tab Width N/A  
 Termination Interface: Style Crimp or Compression  
 Wire Insulation Diameter N/A  
 Wire Size AWG 14, 16  
 Wire Size mm<sup>2</sup> 1.30-2.00

**Electrical**

Voltage - Maximum N/A

**Material Info**

Engineering Number B-179

**Reference - Drawing Numbers**

Product Specification PS-19902-011-001, PS-19902-013-001  
 Sales Drawing SD-19033-001

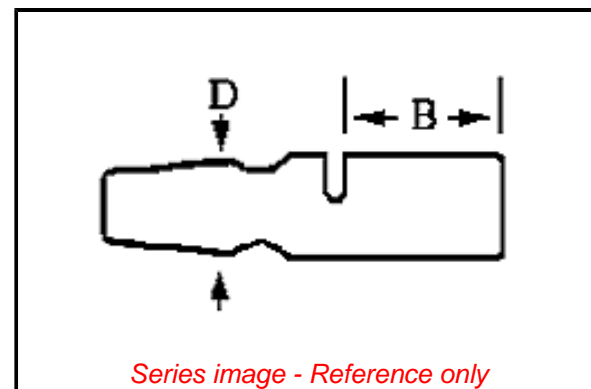

**EU ELV**

**Not Relevant**

**EU RoHS**

**Compliant**

**REACH SVHC**

Not Contained Per  
 -ED/01/2018 (15  
 January 2018)

**Halogen-Free**

**Status**

**Low-Halogen**

**Need more information on product  
 environmental compliance?**

Email [productcompliance@molex.com](mailto:productcompliance@molex.com)  
 Please visit the [Contact Us](#) section for any  
 non-product compliance questions.

China ROHS Green Image  
 ELV Not Relevant  
 RoHS Phthalates Not Contained

**Search Parts in this Series**

19033 Series